



Gas Sampling System

EASY GAS

MAIN CHARACTERISTICS

- ⊕ In accordance with ISTISAN 98/2 and EN 13649;
- ⊕ Constant flow sampler;
- ⊕ Small size and light weight;
- ⊕ Flow rate range between 0.2-1.2l/min;
- ⊕ Volumetric counter for low flow equipped with a thermometer;
- ⊕ Supplied with a battery (included) or 220 Vac power.

DDS/EG Sampling Probe

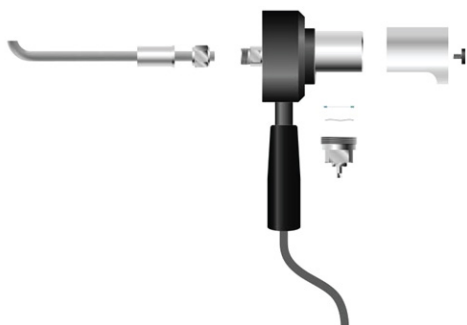

DDS sampler can be used with a sampling probe for gaseous compounds.
For further information, please see **Product Data 1.004.02**

E.G. SAMPLER

The sampler allows a sampling with a flow rate from 0.2 to 1.2 l/min; it is supplied with a rechargeable battery with a 10 hours autonomy.

It is equipped with a volumetric counter for low flow with a thermometer for temperature measurement.

EASY GAS is equipped with a big silica gel trap and a protection filter.

This solution allows to avoid pump damages coming from aggressive stack gases or simply from accidental suction of adsorbing solution.

TECHNICAL CHARACTERISTICS

Flow rate range	from 0.2 to 1.2 l/min
Pump type	Membrane
Dry gas meter	± 2%
Dimensions (b x p x h)	260 x 150 x 300 mm
Weight	6.3 Kg
P/N	AC99-007-0000SP



EASY GAS is supplied with a battery charger/power supply and can be also used from main supply.

